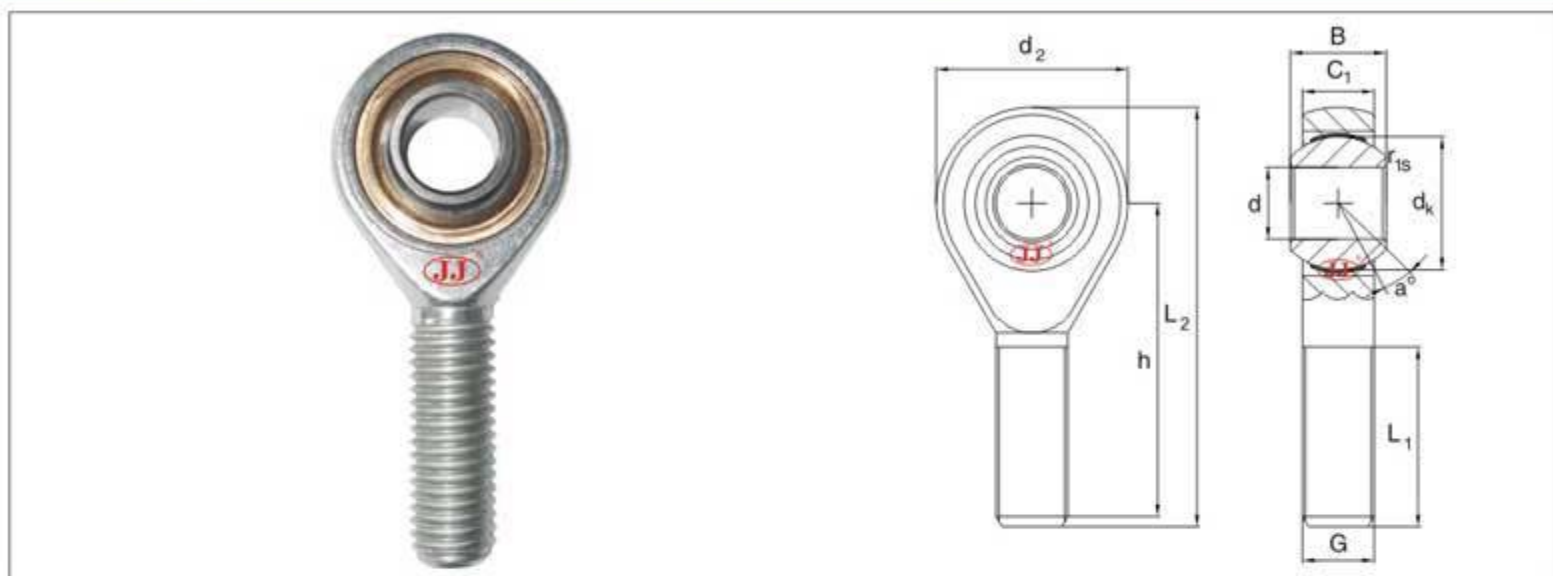

**Rod ends 自润滑组装型杆端关节轴承** [Http://www.jjbearings.cn](http://www.jjbearings.cn)

| 名称                      | 尺寸 Dimensions mm |                    |        |                       |                       |         |     |                       |                       |                        | 转动<br>扭力 | 负荷 kN                             |  | 径向游隙                                  | 重量                        | 库存            |   |
|-------------------------|------------------|--------------------|--------|-----------------------|-----------------------|---------|-----|-----------------------|-----------------------|------------------------|----------|-----------------------------------|--|---------------------------------------|---------------------------|---------------|---|
| 型号<br>Bearing<br>number | d<br>公差<br>H7    | B <sub>±0.12</sub> | dk     | C <sub>1</sub><br>max | d <sub>2</sub><br>max | G<br>6g | h   | L <sub>1</sub><br>min | L <sub>2</sub><br>max | r <sub>1s</sub><br>min | a°       | Rotational<br>torque<br>Nm<br>max | 动<br>Load<br>ratings<br>kN/<br>Dynamic | 静<br>Load<br>ratings<br>kN/<br>Static | Radial<br>clearance<br>mm | Weight<br>≈kg |   |
| SA5T/K                  | 5                | 8                  | 11.112 | 6                     | 18                    | M5      | 33  | 19                    | 42                    | 0.3                    | 13       | 0.2                               | 5.7                                    | 6.0                                   | 0~0.032                   | 0.013         | ✓ |
| SA6T/K                  | 6                | 9                  | 12.7   | 6.75                  | 20                    | M6      | 36  | 21                    | 46                    | 0.3                    | 13       | 0.25                              | 7.2                                    | 7.65                                  | 0~0.032                   | 0.015         | ✓ |
| SA8T/K                  | 8                | 12                 | 15.88  | 9                     | 24                    | M8      | 42  | 25                    | 54                    | 0.3                    | 14       | 0.3                               | 11.6                                   | 12.9                                  | 0~0.032                   | 0.034         | ✓ |
| SA10T/K                 | 10               | 14                 | 19.05  | 10.5                  | 28                    | M10     | 48  | 28                    | 62                    | 0.6                    | 13       | 0.4                               | 14.5                                   | 18                                    | 0~0.032                   | 0.071         | ✓ |
| SA12T/K                 | 12               | 16                 | 22.23  | 12                    | 32                    | M12     | 54  | 32                    | 70                    | 0.6                    | 13       | 0.5                               | 17                                     | 24                                    | 0~0.032                   | 0.110         | ✓ |
| SA14T/K                 | 14               | 19                 | 25.4   | 13.5                  | 36                    | M14     | 60  | 36                    | 78                    | 0.6                    | 16       | 0.6                               | 24                                     | 31                                    | 0~0.04                    | 0.130         | ✓ |
| SA16T/K                 | 16               | 21                 | 28.58  | 15                    | 42                    | M16     | 66  | 37                    | 87                    | 0.6                    | 15       | 0.7                               | 28.5                                   | 39                                    | 0~0.04                    | 0.220         | ✓ |
| SA18T/K                 | 18               | 23                 | 31.75  | 16.5                  | 44                    | M18×1.5 | 72  | 41                    | 94                    | 0.6                    | 15       | 0.8                               | 42.5                                   | 47.5                                  | 0~0.04                    | 0.290         | ✓ |
| SA20T/K                 | 20               | 25                 | 34.93  | 18                    | 50                    | M20×1.5 | 78  | 45                    | 103                   | 0.6                    | 14       | 1.0                               | 42.5                                   | 57                                    | 0~0.04                    | 0.360         | ✓ |
| SA22T/K                 | 22               | 28                 | 38.1   | 20                    | 54                    | M22×1.5 | 84  | 48                    | 111                   | 0.6                    | 15       | 1.2                               | 57                                     | 68                                    | 0~0.05                    | 0.490         | ✓ |
| SA25T/K                 | 25               | 31                 | 42.86  | 22                    | 60                    | M24×4   | 94  | 55                    | 124                   | 0.6                    | 15       | 1.2                               | 68                                     | 85                                    | 0~0.05                    | 0.650         | ✓ |
| SA28T/K                 | 28               | 35                 | 47.63  | 24                    | 66                    | M27×2   | 103 | 62                    | 136                   | 0.6                    | 15       | 1.2                               | 86                                     | 107                                   | 0~0.05                    | 0.870         | ✓ |
| SA30T/K                 | 30               | 37                 | 50.8   | 25                    | 70                    | M30×2   | 110 | 66                    | 145                   | 0.6                    | 17       | 1.2                               | 88                                     | 114                                   | 0~0.05                    | 1.100         | ✓ |
| SA35T/K                 | 35               | 43                 | 57.1   | 28                    | 81                    | M36×2   | 140 | 85                    | 180.5                 | 0.6                    | 16       | 1.2                               | 101                                    | 206                                   | 0~0.05                    | 1.640         | ✓ |
| SA40T/K                 | 40               | 49                 | 66.6   | 33                    | 91                    | M42×2   | 150 | 90                    | 195.5                 | 0.6                    | 17       | 1.2                               | 124                                    | 286                                   | 0~0.05                    | 2.400         | ✓ |
| SA50T/K                 | 50               | 60                 | 82.5   | 45                    | 117                   | M48×2   | 185 | 105                   | 243.5                 | 0.6                    | 12       | 1.2                               | 308                                    | 485                                   | 0~0.05                    | 4.800         | ○ |

Dimensions in mm

Note: For left-hand thread, Please add suffix "L", e. g. SAL20T/K

Sliding contact surfaces: Steel/PTFE composite material

Design and application features:

Rod end of steel and zinc coated, with male or male thread, outer ring of bronze, with sliding surface of PTFE composite material, maintenance-free; inner ring of carbon chromium steel, spherical surface with chromium plating. It has characteristics of large load capability, easy mounting and dismounting and mechanism simplification.