

ADJUSTABLE ANGLE FLANGE BALL BEARING UNITS

UCFA2

(NORMAL DUTY)



SL TYPE SEAL



L3 TYPE SEAL

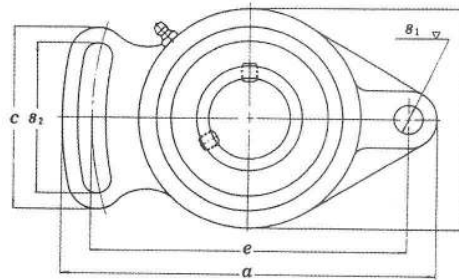
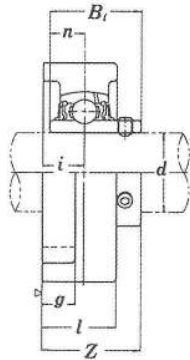

Unit No.	Shaft Dia.		Dimensions (in./mm)											Bolt Used		Bearing No.	Housing No.	Weight (kgf)		
	d		a	e	i	g	l	s ₁	b	Z	s ₂	B _i	n	(mm)	(in.)					
	(in.)	(mm)																		
UCFA 201-8	1/2	12																UC 201-8		0.47
202		15	3 ²¹ / ₃₂	3 ⁵ / ₆₄	3 ⁵ / ₆₄	7 ¹ / ₁₆	1 ⁵ / ₁₆	2 ⁵ / ₆₄	2 ⁵ / ₁₆	1 ¹ / ₄	1 ⁹ / ₁₆	1.2205	0.5000	8	5 ¹ / ₁₆			FA 204		0.45
202-10	5/8	17	98	78	13.8	11	24	10	59	32.1	40	31.0	12.7							0.44
203		20																		0.42
204-12	3/4																			
204																				
UCFA 205-14	7/8		4 ⁷ / ₈	3 ⁵ / ₆₄	5 ⁵ / ₈	1 ¹ / ₂	1 ¹ / ₁₆	7 ¹ / ₁₆	2 ³ / ₄	1 ¹ / ₃	1 ¹ / ₁₆	1.3425	0.5630	10	3 ³ / ₈			UC 205-14		0.68
205-15	15/16	25	124	98	16.0	13	27	11	70	35.7	49	34.1	14.3					FA 205		
205																				
205-16	1																			
UCFA 206-18	1 ¹ / ₆		5 ⁹ / ₁₆	4 ³ / ₆₄	4 ⁵ / ₆₄	1 ¹ / ₂	1 ³ / ₁₆	7 ¹ / ₁₆	3 ⁹ / ₃₂	1 ⁹ / ₁₅	2 ³ / ₁₆	1.5000	0.6260	10	3 ³ / ₈			UC 206-18		1.0
206		30	141	117	17.8	13	30	11	83	40.0	56	38.1	15.9					FA 206		
206-19	1 ¹ / ₈																			
UCFA 207-20	1 ¹ / ₄		6 ³ / ₃₂	5 ¹ / ₈	4 ⁷ / ₆₄	9 ¹ / ₁₆	1 ¹ / ₃₂	3 ³ / ₆₄	3 ² / ₅	1 ² / ₃	2 ¹ / ₃	1.6890	0.6890	12	7 ¹ / ₁₆			UC 207-20		1.5
207-21	1 ⁵ / ₁₆		155	130	18.6	14	34	13	96	44.0	63	42.9	17.5					FA 207		
207-22	1 ³ / ₈	35																		
207																				
207-23	1 ⁷ / ₁₆																			
UCFA 208-24	1 ¹ / ₂		6 ² / ₃	5 ⁴ / ₆₄	1 ³ / ₁₆	9 ¹ / ₁₆	1 ¹ / ₂	3 ² / ₆₄	4 ¹ / ₈	2	2 ³ / ₄	1.9370	0.7480	12	7 ¹ / ₁₆			UC 208-24		1.9
208-25	1 ⁹ / ₁₆	40	171	114	20.8	14	38	13	105	51.0	70	49.2	19.0					FA 208		
208																				
UCFA 209-26	1 ⁵ / ₈		7 ¹ / ₁₆	5 ⁵ / ₆₄	5 ⁵ / ₆₄	9 ¹ / ₁₆	1 ⁹ / ₁₆	1 ⁹ / ₃₂	4 ³ / ₈	2 ¹ / ₁₆	2 ¹ / ₃	1.9370	0.7480	14	1 ¹ / ₂			UC 209-26		1.7
209-27	1 ¹ / ₁₆		179	148	21.8	14	40	15	111	52.0	72	49.2	19.0					FA 209		
209-28	1 ³ / ₄	45																		
209																				
UCFA 210-30	1 ⁷ / ₈		7 ⁷ / ₁₆	6 ³ / ₁₆	5 ⁷ / ₆₄	9 ¹ / ₁₆	1 ⁹ / ₁₆	1 ⁹ / ₃₂	4 ⁹ / ₁₆	2 ⁵ / ₃₂	2 ¹ / ₁₆	2.0315	0.7480	14	1 ¹ / ₂			UC 210-30		2.0
210-31	1 ¹⁵ / ₁₆		189	157	22.5	14	40	15	116	55.1	75	51.6	19.0					FA 210		
210		50																		
210-32	2																			
UCFA 211-32	2		8 ¹ / ₂	7 ¹ / ₄	1 ¹ / ₆₄	2 ⁵ / ₃₂	1 ² / ₃	5 ⁸ / ₁₆	5 ¹ / ₄	2 ⁵ / ₁₆	3 ³ / ₈	2.1890	0.8740	15	9 ¹ / ₁₆			UC 211-32		3.6
211-34	2 ¹ / ₈	55	216	184	25.7	20	44	16	133	59.1	86	55.6	22.2					FA 211		
211																				
211-35	2 ³ / ₁₆																			