

ONE SIDE BRACKET FLANGE BALL BEARING UNITS

UCFB2

NORMAL DUTY

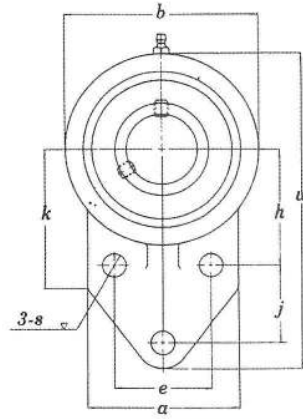
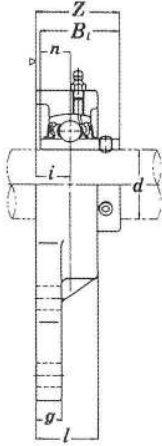

Unit No.	Shaft Dia.		Dimensions (in.) (mm)														Bolt Used		Bearing No.	Housing No.	Weight (kgf)	
	d		w	b	k	a	l	s	g	h	j	e	i	Z	Bi	n	(mm)	(in)				
	(in.)	(mm)															(mm)	(in)				
UCFB 201-8 201-8 202 202-10 203 204-12 204	1/2 5/8 3/4	12 15 17 20																		UC 201-8 201-8 202 202-10 203 204-12 204	FB 204	0.64 0.62 0.61 0.59
UCFB 205-14 205-15 205 205-16	7/8 15/16 1	25	49/16 116	211/16 68	21/16 52	27/32 56	11/32 26	3/8 9.5	1/2 13	149/64 45	11/16 27	111/32 34	19/32 15	13/8 34.7	1.3425 34.1	0.5630 14.3	8	5/16	UC 205-14 205-15 205 205-16	FB 205	0.68	
UCFB 206-18 206 206-19	11/8 13/16	30	51/8 130	31/16 78	25/32 55	29/16 65	15/32 29	3/8 9.5	1/2 13	131/32 50	19/64 29	137/64 40	43/64 17	117/32 39.2	1.5000 38.1	0.6260 15.9	8	5/16	UC 206-18 206 206-19	FB 206	0.92	
UCFB 207-20 207-21 207-22 207 207-23	11/4 15/16 3/8 17/16	35	521/32 144	317/32 90	27/16 62	23/4 70	15/16 33	3/8 9.5	19/32 15	211/64 55	117/64 32	113/16 46	3/4 19	13/4 44.4	1.6890 42.9	1.6890 17.5	8	5/16	UC 207-20 207-21 207-22 207 207-23	FB 207	1.3	
UCFB 208-24 208-25 208	11/2 19/16	40	615/32 164	315/16 100	227/32 72	31/16 78	111/32 34	7/16 11.1	5/8 16	223/64 60	139/64 41	131/32 50	25/32 20	131/32 50.2	1.9370 49.2	0.7480 19.0	10	3/8	UC 208-24 208-25 208	FB 208	1.8	
UCFB 209-26 209-27 209-28 209	15/8 111/16 13/4	45	627/32 174	43/16 106	3 76	35/32 80	111/32 34	7/16 11.1	23/32 18	29/16 65	111/16 43	21/8 54	25/32 20	131/32 50.2	1.9370 49.2	0.7480 19.0	10	3/8	UC 209-26 209-27 209-28 209	FB 209	2.0	
UCFB 210-30 210-31 210 210-32	17/8 115/16 2	50	71/4 184	413/32 112	37/32 82	33/8 86	13/8 35	7/16 11.1	23/32 18	243/64 68	113/16 46	29/32 58	25/32 20	21/16 52.6	2.0315 51.6	0.7480 19.0	10	3/8	UC 210-30 210-31 210 210-32	FB 210	2.3	