

TAKE-UP BALL BEARING UNITS

UCT2

(NORMAL DUTY)



SL TYPE SEAL,



L3 TYPE SEAL

DOUBLE PROTECTION METHOD (STAMPED STEEL COVER)

UCT2-C... WITH COVER, BOTH SIDES OPEN

UCT2-CD... WITH COVER, ONE SIDE CLOSED

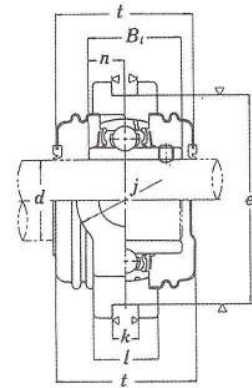
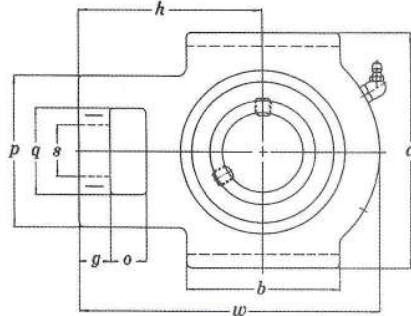
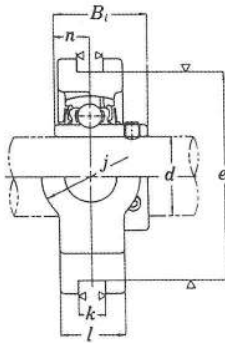

Unit No.	Shaft d		Dimensions (in./mm)														Bearing No.	Housing No.	Weight (kgf)			
	(in.)	(mm)	o	g	p	q	s	b	K	e	a	w	j	l	h	t				Bi	n	
UCT 201-8 202-10 203 204-12 204	1/2	12																		UC 201-8 202-10 203 204-12 204	T 204	0.81 0.79 0.78 0.76
	5/8	15	5/8	13/32	2	11/4	3/4	2	15/32	263/64	31/2	311/16	11/4	13/16	213/32	23/32	1.2205	0.5000				
	3/4	17	16	10	51	32	19	51	12	76	89	94	32	21	61	44	31.0	12.7				
	3/4	20																				
UCT 205-14 205-15 205 205-16	7/8		5/8	13/32	2	1/4	3/4	2	15/32	263/64	31/2	313/16	11/4	15/16	27/16	17/8	1.3425	0.5630	UC 205-14 205-15 205 205-16	T 205	0.84	
	15/16	25	16	10	51	32	19	51	12	76	89	97	32	24	62	48	34.1	14.3				
	1																					
UCT 206-18 206 206-19	1 1/8		5/8	13/32	2 7/32	1 15/32	5 5/64	2 1/4	1 15/32	3 1/2	4 1/32	4 7/16	1 15/32	1 13/32	2 3/4	2 1/16	1.5000	0.6260	UC 206-18 206 206-19	T 206	1.3	
	1 3/16	30	16	10	56	37	22	57	12	89	102	113	37	28	70	52	38.1	15.9				
UCT 207-20 207-21 207-22 207 207-23	1 1/4		5/8	1/2	2 17/32	1 15/32	5 5/64	2 17/32	1 15/32	3 1/2	4 1/32	5 3/32	1 15/32	1 13/16	3 1/16	2 5/16	1.6890	1.6890	UC 207-20 207-21 207-22 207 207-23	T 207	1.6	
	1 5/16	35	16	13	64	37	22	64	12	89	102	129	37	30	78	59	42.9	17.5				
	1 3/8																					
	1 7/16																					
UCT 208-24 208-25 208	1 1/2		3/4	5/8	3 9/32	1 15/16	1 9/64	3 9/32	5/8	4 1/64	4 1/2	5 21/32	1 15/16	1 15/16	3 15/32	2 11/16	1.9370	0.7480	UC 208-24 208-25 208	T 208	2.5	
	1 9/16	40	19	16	83	49	29	83	16	102	114	144	49	33	88	68	49.2	19.0				
UCT 209-26 209-27 209-28 209	1 5/8		3/4	5/8	3 9/32	1 15/16	1 9/64	3 9/32	5/8	4 1/64	4 19/32	5 21/32	1 15/16	1 13/8	3 7/16	2 11/16	1.9370	0.7480	UC 209-26 209-27 209-28 209	T 209	2.4	
	1 11/16	45	19	16	83	49	29	83	16	102	117	144	49	35	87	68	49.2	19.0				
	1 3/4																					
UCT 210-30 210-31 210 210-32	1 7/8		3/4	5/8	3 9/32	1 15/16	1 9/64	3 3/8	5/8	4 1/64	4 19/32	5 7/8	1 15/16	1 15/32	3 17/32	2 7/8	2.0315	0.7480	UC 210-30 210-31 210 210-32	T 210	2.6	
	1 15/16	50	19	16	83	49	29	86	16	102	117	149	49	37	90	73	51.6	19.0				
UCT 211-32 211-34 211 211-35	2		1	3/4	4 1/32	2 17/32	1 3/8	3 3/4	5 5/64	5 1/8	5 3/8	6 23/32	2 17/32	1 1/2	4 3/16	2 15/16	2.1890	0.8740	UC 211-32 211-34 211 211-35	T 211	4.0	
	2 1/8	55	25	19	102	64	35	95	22	130	146	171	64	38	106	75	55.6	22.2				
	2 3/16																					
UCT 212-36 212 212-38 212-39	2 1/4		1 1/4	3/4	4 1/32	2 17/32	1 3/8	4 1/32	5 5/64	5 1/8	5 3/4	7 5/8	2 17/32	1 21/32	4 11/16	3 15/32	2.5630	1.0000	UC 212-36 212 212-38 212-39	T 212	4.9	
	2 3/8	60	32	19	102	64	35	102	22	130	146	194	64	42	119	88	65.1	25.4				
	2 7/16																					
UCT 213-40 213	2 1/2		1 1/4	13/16	4 3/8	2 3/4	1 39/64	4 3/4	1 1/32	5 15/16	6 9/16	8 13/16	2 3/4	1 23/32	5 13/32	3 15/32	2.5630	1.0000	UC 213-40 213	T 213	6.9	
		65	32	21	111	70	41	121	26	151	167	224	70	44	137	88	65.1	25.4				
UCT 214-44 214	2 3/4		1 1/4	13/16	4 3/8	2 3/4	1 39/64	4 3/4	1 1/32	5 15/16	6 9/16	8 13/16	2 3/4	1 11/16	5 13/32	3 27/32	2.9370	1.1890	UC 214-44 214	T 214	7.0	
		70	32	21	111	70	41	121	26	151	167	224	70	46	137	98	74.6	30.2				
UCT 215 215-48	3		1 1/4	13/16	4 3/8	2 3/4	1 39/64	4 3/4	1 1/32	5 15/16	6 9/16	9 1/8	2 3/4	1 17/8	5 1/2	3 27/32	3.0630	1.3110	UC 215 215-48	T 215	7.3	
		75	32	21	111	70	41	121	26	151	167	232	70	48	140	98	77.8	33.3				
UCT 216		80	1 1/4	13/16	4 3/8	2 3/4	1 39/64	4 3/4	1 1/32	6 1/2	7 1/4	9 1/4	2 3/4	2	5 1/2	4 1/4	3.2520	1.3110	UC 216	T 216	8.2	
			32	21	111	70	41	121	26	165	184	235	70	51	140	108	82.6	33.3				
UCT 217-52 217	3 1/4		1 1/2	1 5/32	4 7/8	2 7/8	1 57/64	6 3/16	1 13/16	6 13/16	7 25/32	10 1/4	2 7/8	2 1/8	6 3/8	4 13/32	3.3740	1.3425	UC 217-52 217	T 217	11.0	
		85	38	29	124	73	48	157	30	173	198	260	73	54	162	112	85.7	34.1				