

Spherical Roller Thrust Bearings

Bore Diameter: 480~530mm

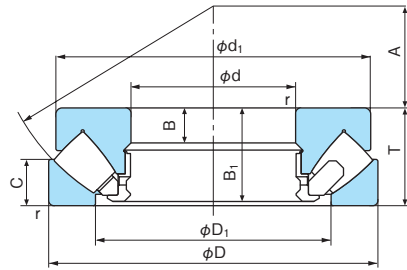

Type E

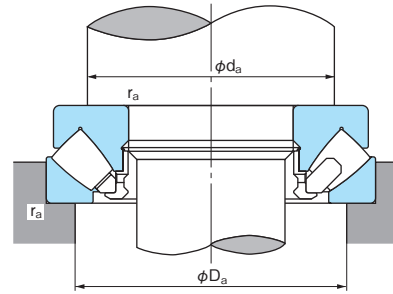

Dynamic equivalent axial load
 $P_a = F_a + 1.2F_r$
Static equivalent axial load
 $P_{0a} = F_a + 2.7F_r$
 where, F_a : Axial load
 F_r : Radial load
 However $\frac{F_r}{F_a} \leq 0.55$
 However $F_r/F_a \leq 0.55$ must be satisfied

1N=0.102kgf

Boundary dimensions (mm)				Bearing No.	Basic dynamic load rating C_a (N)	Basic static load rating C_{0a} (N)	Limiting speed (min ⁻¹)		Reference Dimensions (mm)						Abutment and fillet dimensions (mm)			Spacer dimensions (mm)		Mass (kg) (Reference)	Bearing No.
d	D	T	r (min)				Grease lubrication	Oil lubrication	d ₁	D ₁	B	B ₁	C	A	d _a (min)	D _a (max)	r _a (max)	db ₁ (max)	db ₂ (max)		
480	650	103	5	29296E	2530000	13200000	—	600	635	556	33	99	55	259	555	595	4.0	—	—	97.5	29296E
	730	150	6	29396E	4630000	21900000	—	410	705	590	51	144	72	270	595	650	5.0	—	—	224	29396E
	850	224	9.5	29496E	8250000	36000000	—	260	810	638	81	216	108	280	645	730	8.0	—	—	543	29496E
500	670	103	5	292/500E	2590000	13800000	—	600	654	574	33	99	55	268	575	615	4.0	—	—	101	292/500E
	750	150	6	293/500E	4700000	22600000	—	410	725	611	51	144	74	280	615	670	5.0	—	—	231	293/500E
	870	224	9.5	294/500E	8250000	35000000	—	250	830	661	81	216	107	290	670	750	8.0	—	—	559	294/500E
530	710	109	5	292/530E	2820000	15100000	—	540	692	612	35	105	57	288	615	653	4.0	—	—	106	292/530E

Note: For heavy load application, d_a should be large enough to support the shaft washer rib.